

Haarup Mixer Standard Type VM500

Modstrømsblander
Counterflow Mixer
Gegenstrommischer

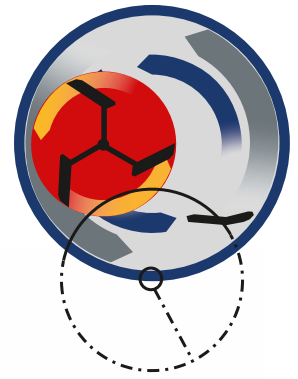

Haarup

Haarup North America, Inc.
12695 NE Marx Street · Building #12
Portland, OR 97230

Tel.: +1 503-954-1718 · Fax: +1 503-206-8892

HaarupNA@haarup.com · www.haarup.com

Haarup Maskinfabrik A/S
Haarupvej 20 · DK-8600 Silkeborg

Tel.: +45 86 84 62 55 · Fax: +45 86 84 53 77

haarup@haarup.dk · www.haarup.dk
www.haarup.de

Haarup Mixer Standard Type VM500

Modstrømsblander
Counterflow Mixer
Gegenstrommischer

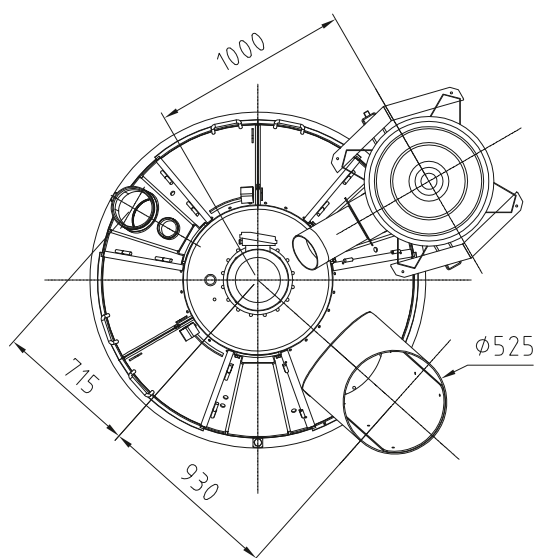
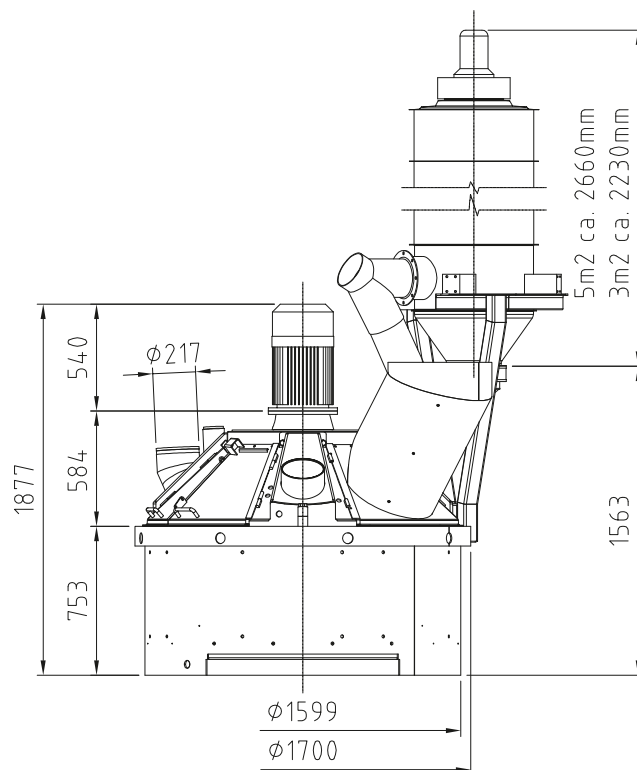
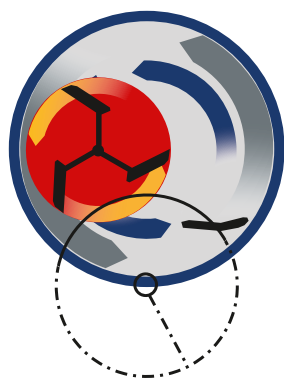

Blander		Mixer		Mischer		VM500
Max. ifyldte råmaterialer	(l) (kg) (Lbs)	Max. Input raw materials	(litre) (kg) (Lbs)	Max. Gesamtfüllung	(l) (kg) (Lbs)	500 800 1765
Færdig betonmængde jordfugtig beton	(l) (yd ³)	Capacity Semi-dry concrete	(litre) (yd ³)	Fertige Betonmenge erdfuchter Beton	(l) (yd ³)	333 0,46
Motoreffekt (kW)/ (hp)		Power (kW)/ (hp)		Motorleistung (kW)/ (hp)		15/20
Egenvægt (kg)		Own weight (kg)		Eigengewicht in (kg)		2200